



Square Safety Bollard

Engineered Protection for Critical Infrastructure

Cleenergy’s square security bollard provides strong, reliable protection for valuable assets across commercial, industrial, and residential environments. Designed with both durability and visual appeal in mind, it protects equipment, infrastructure, and property while integrating seamlessly into modern spaces.

Key Features

Universal Compatibility

Designed to protect a wide range of equipment including energy storage systems, electrical cabinets, water infrastructure, warehouse equipment, and EV charging stations. The simple footprint allows easy integration into existing site layouts.

Versatile Applications

Ideal for warehouses, logistics centres, commercial buildings, car parks, public infrastructure areas, and residential installations where physical protection of valuable assets is required.

Safety First

Engineered to create a strong physical barrier, the square bollard protects sensitive infrastructure such as electrical equipment, energy storage systems, water services, and warehouse assets from accidental vehicle impact.

Clean Architectural Design

The square profile offers a modern and structured appearance that aligns with contemporary commercial and industrial environments. Its clean geometry integrates naturally into building landscapes, car parks, and service areas.

Hot-Dip Galvanised Steel Protection

The bollard is manufactured using hot-dip galvanised steel, a process where the finished steel structure is immersed in molten zinc. This creates a protective coating that bonds metallurgically to the steel surface.

The result is a durable protective layer that:

- Protects against corrosion and rust
- Provides long-term durability in outdoor environments
- Maintains structural strength in harsh conditions
- Requires minimal maintenance over time

Hot-dip galvanising ensures the bollard remains resilient in exposed industrial, coastal, and urban environments.

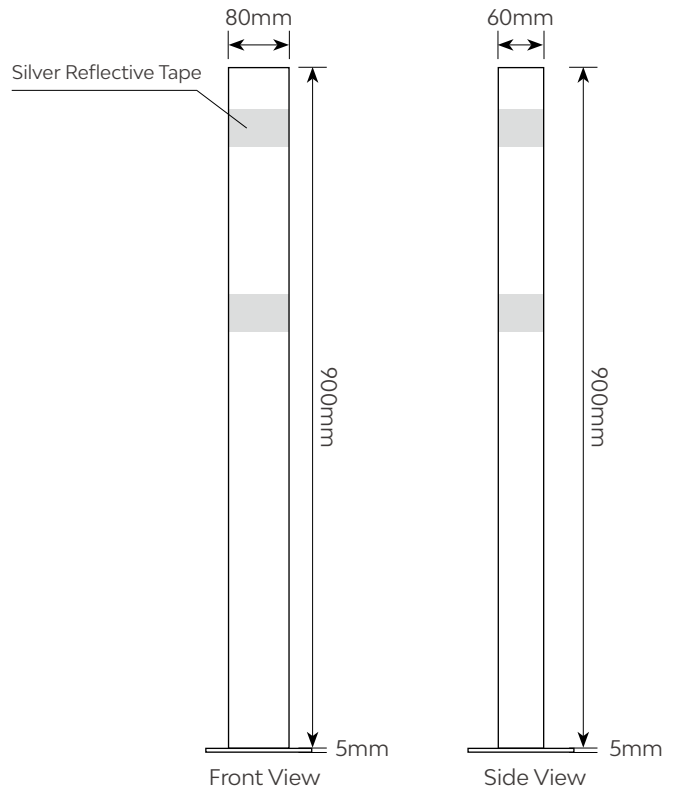
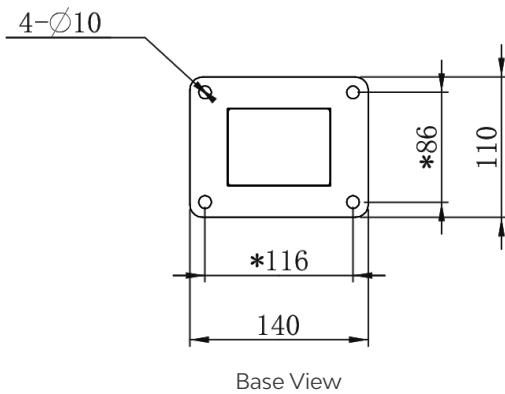
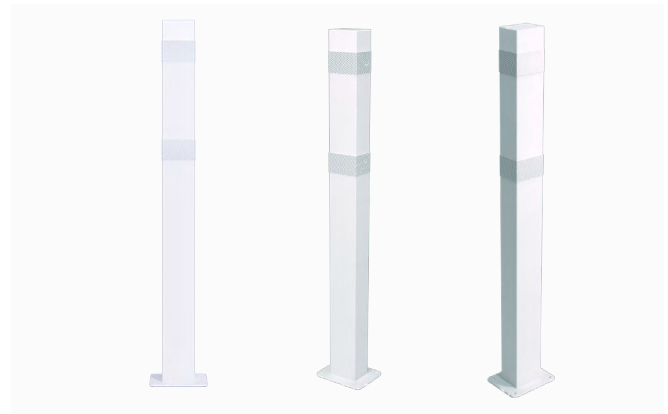

Model Name	BPB L900W
Surface Treatment	Hot Dip Galvanized Steel
Color	Power Coated
Bollard Dimensions	900 x 80 x 60 mm
Base Dimensions	140 x 110 x 5 mm
Weight	4.4 kg
Anchoring	4 x Screws

Clenergy Infrastructure Heritage

For over 19 years, Clenergy has engineered metal infrastructure solutions supporting the global transition to renewable energy. Our solar mounting systems and structural components are installed in projects across residential, commercial, and utility-scale environments worldwide. This deep experience in designing reliable metal structures now extends into physical infrastructure protection.

With the introduction of our bollard range, Clenergy brings the same engineering principles that support solar infrastructure to protecting the systems that power modern buildings. From rooftop solar structures to ground-level infrastructure protection, Clenergy continues to provide the structural foundation that supports safe and resilient environments for homes, workplaces, and critical services.