

## MT-Rail Cable Tray Cover

### Assembly

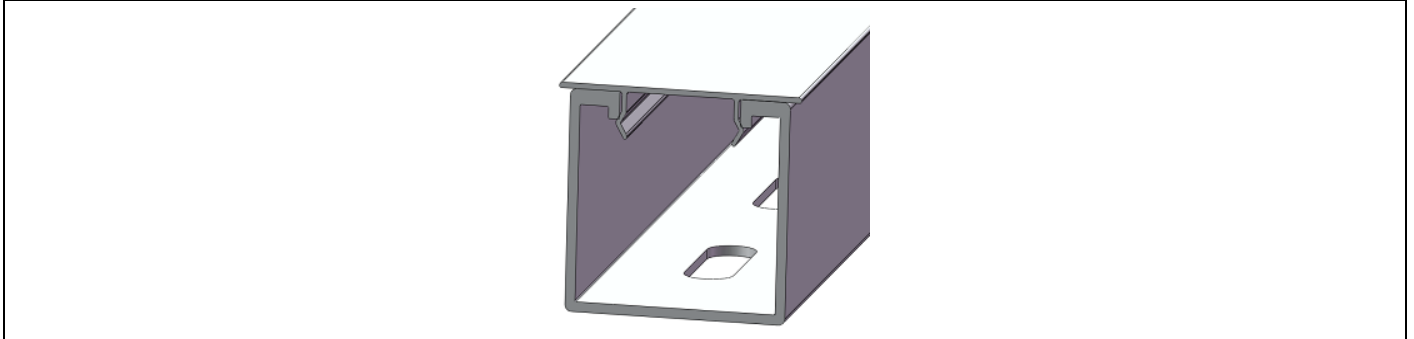

### Component

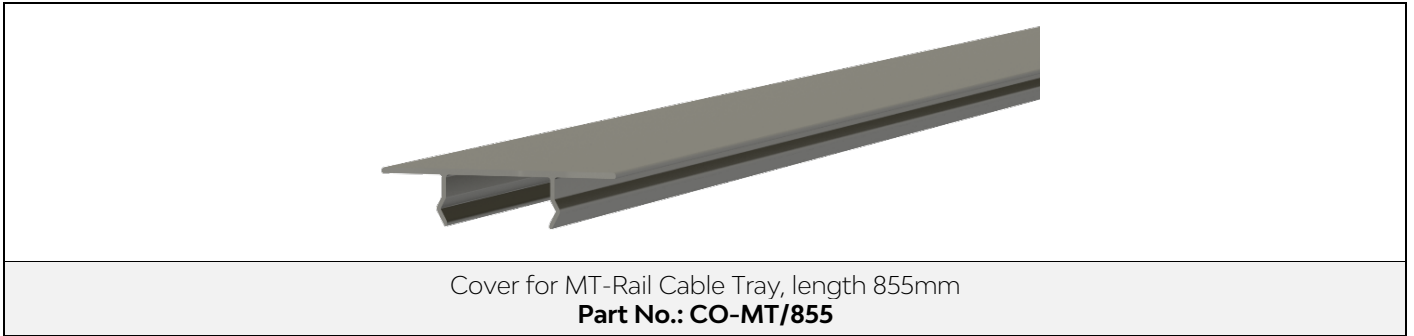

### Technical Specification

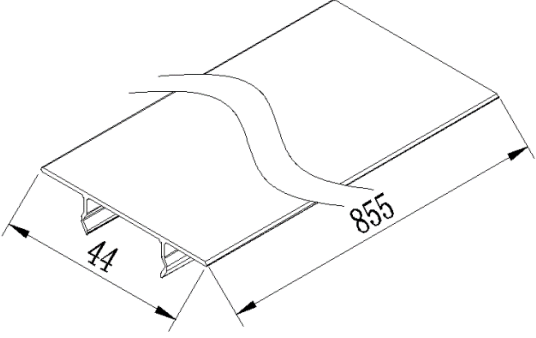
Application	Cover for MT-Rail Cable Tray	
Fixing Method	Click in MT-Rail Cable Tray	
Dimensions	L855mm*W44mm*H9.52mm	
Weight	0.135 kg	
Packaging	30 units per carton	
Material	AL6005-T5	
Finish	Mill Finish	
Standard	AS NZS1170.2-2011	